





OFFERED WITH NO CHAIN

3 Bedroom mid-terrace house

67 Warton Street Lytham Saint
Annes FY8 5DG

OIRO £310,000

Property Features

-  Mid-terrace House
-  1 bathrooms
-  1,140 sq. ft.
-  3 bedrooms
-  Fantastic location -
///campfires.rooks.out
doors
-  Front garden and
rear yard

CONTACTS

James Ashworth and Colman Bernard

T: 0161 967 0122

E: james.ashworth@landwoodgroup.com

E: colman.bernard@landwoodgroup.com



LANDWOOD
GROUP



67 Warton Street Lytham Saint Annes FY8 5DG

DESCRIPTION

Offered chain free!

The property offers the buyer to acquire a 3 bedroom mid-terrace, located in a desirable area and convenient for all the town has to offer.

The ground floor opens into a small porch leading to a hallway, with a reception room at the front and a dining room or second reception room to the rear. The kitchen is located at the back of the ground floor. Stairs from the hallway lead up to the first-floor landing, with a family bathroom, along with two double bedrooms and one single bedroom. There's a loft ladder leading to useful attic storage.

Central heating is via a gas boiler (not tested) and there are two period effect gas fires to each of the reception rooms.

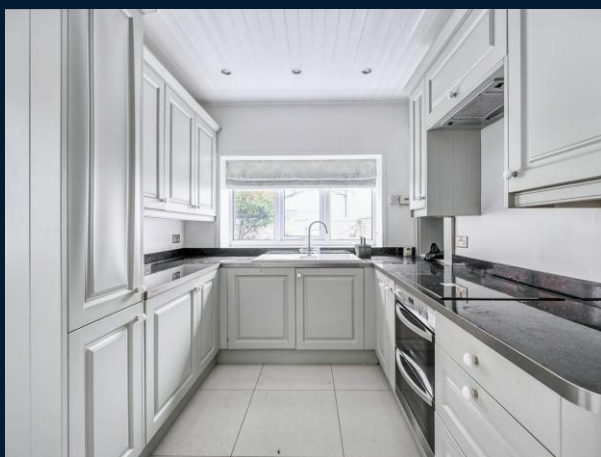

Settle into Your SURROUNDINGS

LOCATION

The property occupies a convenient position on Warton Street, benefiting from being a short walk from Lytham Green, close proximity to local amenities such as the Post Office, easy access to transport links with Lytham Station within 0.5 mile (Preston and Blackpool within 15 and 10 minutes respectively and local bus routes running along the street itself).

There is a Booths supermarket within is 0.25 mile and the town centre is within 0.5 mile with a number of national and local retailers available, as well as boutique shops, independent cafes, bars, and restaurants.

Lytham is considered less “touristy” than nearby St Annes and is known as a desirable coastal suburb within Lytham St Annes, known for its affluent, low-key seaside feel.



TENURE INFORMATION

Leasehold for 999 years from 1 May 1923 at a ground rent of £6 per annum.

ACCOMMODATION

For room dimensions see attached floor plan.

OUTSIDE

At the front of the property is a small garden area and at the rear there is an enclosed rear yard.

PRICE

Offers in the region of £310,000.

LEGAL COSTS

Each party will be responsible for their own legal costs.

VIEWINGS

Strictly by appointment.

VIRTUAL TOUR

<https://www.madesnappy.co.uk/tour/1g470g237ff>

EPC

Energy Asset rating is D.

Council Tax

Band C – Annual Charge for 2025/2026 will be £2,130.70.



JAMES ASHWORTH

Partner

T: 0161 967 0122

E: james.ashworth@landwoodgroup.com

L: Lancaster Buildings, 77 Deansgate, Manchester, M3 2BW



COLMAN BERNARD

Graduate Surveyor

T: 0161 967 0122

E: colman.bernard@landwoodgroup.com

L: Lancaster Buildings, 77 Deansgate, Manchester, M3 2BW

Landwood Commercial (Manchester) Ltd for themselves and for the Vendors or Lessors of this property, whose agents they are, give notice that: 1) The information contained within these particulars has been checked and is understood to be materially correct at the date of publication; 2) All descriptions, statements, dimensions, references to condition and permissions for the use and occupation or other details are given in good faith; however, they are made without responsibility and should not be relied upon as representation of fact, intended purchasers or lessors should, by enquiry to our Manchester office, satisfy themselves as to the corrections and availability, in each case, before arrangements are made to view (if the site comprises of buildings); 3) Unless otherwise stated, all prices rents and other charges are quoted exclusive of Value Added Tax (VAT). Any intended purchasers or tenants must satisfy themselves independently as to the incidence of VAT in respect of any transaction; 4) All plant, machinery, equipment, services and fixtures and fittings referred to in these particulars were present at the date of publication. They have not, however, been tested and therefore we give absolutely no warranty as to their condition or operation; 5) These particulars do not constitute part of an offer or contract; 6) The vendors or lessors do not make or give – and neither do Landwood Commercial (Manchester) Ltd, nor any person in their employment have any authority to make or give – any representation or warranty whatsoever in relation to this property.

Approx Gross Internal Area
106 sq m / 1140 sq ft

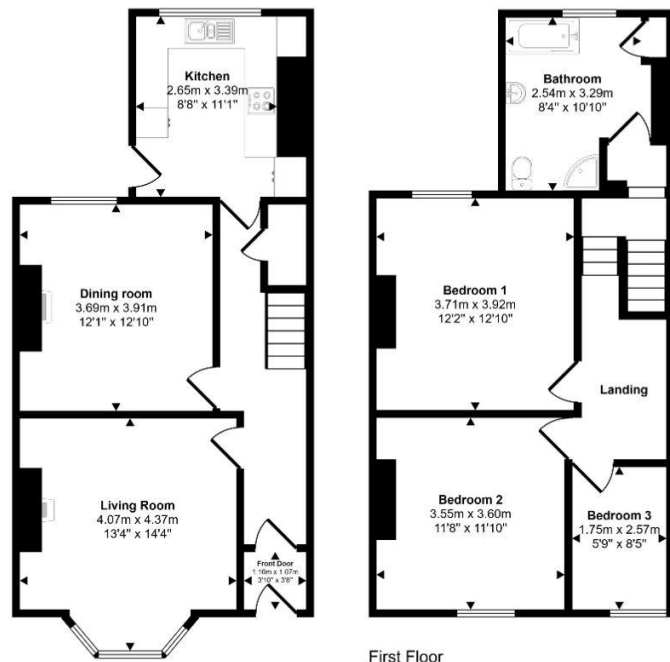

Ground Floor
Approx 54 sq m / 580 sq ft

First Floor
Approx 52 sq m / 560 sq ft

Whilst every attempt has been made to ensure the accuracy of the floor plan contained here, measurements of doors, windows, rooms and any other items are approximate and no responsibility is taken for any error, omission, or mis-statement. The measurements should not be relied upon for valuation, transaction and/or funding purposes. This plan is for illustrative purposes only and should be used as such by any prospective purchaser or tenant.